

ZAKŁAD IZOLATORÓW ELEKTROTECHNICZNYCH  
BOPLAST Sp. z o.o.

Adres:

ul. B.Krzywoustego 1,  
tel. +48 59 862 01 86;  
www.boplast.pl

84-300 Lębork  
tel. 516 198 886  
e-mail: boplast@boplast.pl

IZOLATORY WSPORCZE \* IZOLATORY PRZEPUSTOWE \* WYROBY IZOLACYJNE \* USŁUGI

## Post insulator C kV type IWT-250.bp2

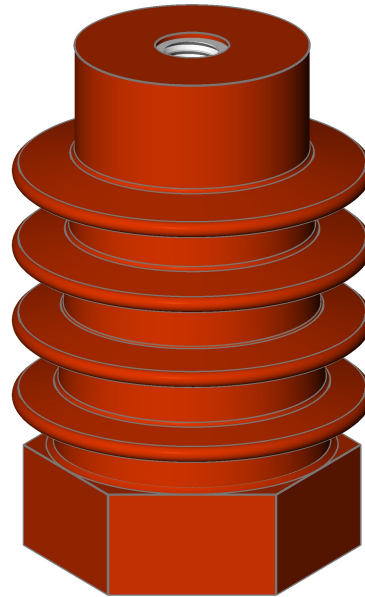
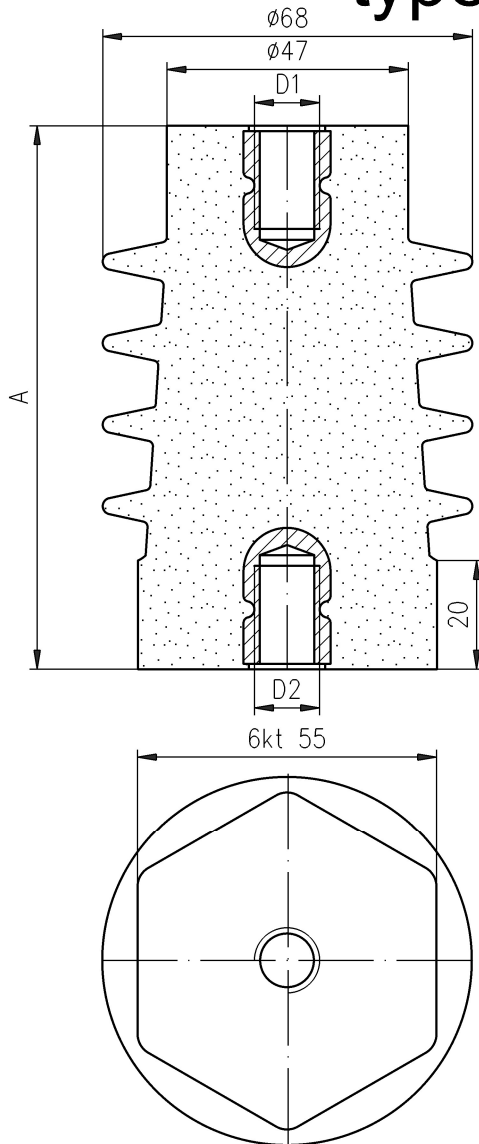

1. Insulator material:  
epoxy compound
2. Parameters according to PN-IEC 60273
3. Tested according to PN-EN 60660
4. Max screw tightening torque:
  - M6 - 7 Nm
  - M8 - 20 Nm
  - M10 - 30 Nm
  - M12 - 50 Nm
5. Indoor insulator

09	80	140	6	45	15	M12	M12	0,4
08	85	145	6	60	28	-	M8	0,4
07	100	161	7,2	60	28	M8	M10	0,5
06	90	151	7,2	60	28	M10	M10	0,5
05	100	161	7,2	60	28	M10	M10	0,5
04	100	161	7,2	60	28	M8	M8	0,5
03	100	161	7,2	60	28	M6	M12	0,5
02	85	145	6	60	28	-	M10	0,4
01	100	161	7,2	60	28	M12	M12	0,5
ver. dim.	A	B	C	D	E	D1	D2	F

Rated insulation voltage	C kV
Lightning impulse withstand voltage	D kV
Dry withstand alternate voltage (50Hz, 1 min)	E kV
Bending strength Po	4 kN
Creepage distance	B mm
Weight	F kg

*Possible to make screws according to client's requirements.*

All data can be changed due to technological progress

DT BP.1.039 z dnia 21.05.2019

1. Order example:

Post insulator 7,2 kV; type IWT-250.bp2.01 with M12/M12 screws.

2. Order example:

Post insulator 6 kV; type IWT-250.bp2.08 with M8 screws.